



T170 / T270 / T370



KENWORTH.
The World's Best.





T170 / T270 / T370



VERSATILE

PRODUCTIVE

EFFICIENT

IF YOU DEPEND ON MEDIUM-DUTY TRUCKS TO MAKE A LIVING, INVEST IN ONE THAT HAS SOME HEAVY-DUTY THINKING BEHIND IT.

Ready for a medium-duty truck that will likely outlive the body you put on it? Then take a close look at the Kenworth T170, T270 and T370 – trucks custom engineered and built with your long-term business goals in mind.

No matter which model you select, you start with a versatile, rugged and reliable chassis capable of tackling the toughest jobs you've got. Then add advantages like contemporary aerodynamic styling, great visibility, excellent maneuverability, a driver-pleasing premium interior and quick single point daily maintenance checks.

These are trucks you can count on – day in, day out.

A straight truck in a 4 x 2 configuration with a gross vehicle weight rating up to 19,500 lbs, the Kenworth T170 is a robust Class 5 model designed to go the distance. The T270 is a true Class 6 vehicle, rated at 26,000 lbs GVW. Available as a straight truck, it can be configured for non-CDL operation to broaden your pool of drivers. The Class 7 T370, as a straight truck or tractor, offers a GVW range from 26,001 to 66,000 lbs.

Custom built from the ground up for your specific application, you can choose manual or automatic transmissions, air or hydraulic brakes and select from components by proven North American manufacturers.

RELIABLE

MANEUVERABLE



OF COURSE YOU HAVE CHOICES. THIS IS YOUR KENWORTH.

Your medium-duty Kenworth is available with job-specific and appearance options. Here are just a few of them.



Kenworth-built polished aluminum fuel tanks in multiple diameters and capacities to meet your needs. New options include end of frame between rails fuel tanks.



Heated and electronically-adjusted aerodynamic mirrors.



Easy-to-operate dash control panel for Eaton automated and Allison automatic transmissions.



The optional narrow battery box under cab with DEF tank give you the room you need. You can also spec out an optional narrow toolbox on the passenger side.



Factory installed front drive axles with capacities from 10,000 to 16,000 lbs. Non-driving front axles from 8,000 to 20,000 lbs.



In addition to the standard peeper window in the passenger door, optional cab corner windows are available to help improve visibility in tight places.

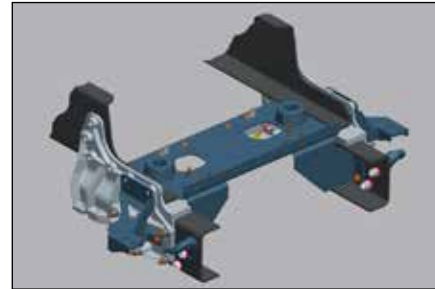

Add a Heavy-Duty Front Frame Extension to simplify the addition of outriggers, winches and specialty bumpers to the Kenworth T370.



Optional center console with two power ports, cup holder and convenient storage.



An advanced forward lighting system provides up to 30% more down-road coverage than conventional sealed beam designs. Choose the standard halogen or optional HID Xenon lamps.



The four-piece hood and fenders are molded from SMC, a high-tech light weight composite material for added durability and reparability.



All new instrumentation with increased gauge and switch options, plus the updated gray dash panels complement the standard Pinnacle Kenworth interior. Shown with optional Nav+ HD display and tilt and telescoping steering column.



The optional Apex interior sets new standards in driver comfort for medium duty trucks, providing a cloth headliner and back panel. Optional Trust Walnut dash panels add to the Kenworth World's Best image and quality. Shown with optional Nav+ HD display.



SAVING MONEY ON MAINTENANCE STARTS RIGHT HERE

With the Kenworth T170, T270 and T370, things are quicker to get to, less strenuous to take apart and faster to put back together – which means less downtime and lower repair bills. The hood tilts a full 90 degrees for wide-open access to the engine and all service points. Even daily inspections have been simplified with all fluid level checks – coolant, oil, power steering and windshield washer reservoir – located in one easy-to-reach place.

At the heart of these vehicles beats a fully optimized and integrated drivetrain featuring the quality and proven reliability of the PACCAR PX engine. Expect longer service intervals, increased uptime, lower operating costs and higher resale value.



PACCAR PX-7



PACCAR PX-9

T170 AND T270 CLASS 6 AND T370 CLASS 7 SPECIFICATIONS

Power / Drivetrain

- PACCAR PX-7 Engine, 6.7 Liter, 200-325 HP, 520 – 750 lb-ft of Torque
- PACCAR PX-9 Engine, 8.9 Liter, 260-350 HP, 660 – 1,150 lb-ft of Torque
- CARB Emission Reduction Feature Available

Starting & Charging

- Multiplex Electrical System With Centralized Power Distribution Incorporating Plug-In Style Relays & Circuit Protection For Serviceability
- 12 Volt Lighting System With Circuit Protection
- Circuits Numbered & Color Coded
- Key Switch Start & Shutdown
- PACCAR 130 Amp Brushless Alternator
- PACCAR 12 Volt Starter
- Two PACCAR Dual Purpose Batteries
- Three PACCAR Dual Purpose Batteries
- Two or Three Optima Deep Cycle Batteries
- Horizontal Muffler/DPF/SCR and Tailpipe

Transmission Options

- Eaton Fuller FS5406A Synchronized 6-Speed
- Clutch - Eaton Fuller
- Eaton Fuller 6, 9 & 10 Speed Transmissions
- Eaton Ultrashift Plus 10-Speed Automated Manual
- Allison 5 & 6 Speed Automatic Transmissions
- PTO Options

Frame / Axle / Suspension / Brakes

- Frame - 10 5/8" Steel - 120,000 psi - Heat Treated
- Frame - 9 7/8" Steel - 120,000 psi - Heat Treated
- Frame - 10 3/4" Steel - 132,000 psi - Heat Treated
- Heavy Duty Front Frame Reinforcement Brackets
- Front Axles - 10,000 lb.
- Front Axles - Meritor 12,000 to 20,000 lbs.
- Front Axles - Dana Spicer 8,000 to 20,000 lbs.
- Front Drive Axles - Fabco 10,000 to 16,000 lbs.
- Front Springs - Taperleaf w/Shocks, 10,000 lb.
- Front Springs - Taperleaf w/Shocks, 12,000, 13,200, 14,600, 16,000, 18,000 and 20,000 lb.
- Rear Axle - 21,000 lb.
- Single Rear Axles - Meritor from 21,000 to 30,000 lb.
- Tandem Rear Axles - Meritor 40,000 and 46,000 lb.
- Tandem Rear Axles - Dana Spicer, 40,000 and 44,000 lb.
- Rear Suspension - Reyco, 20,000 lb.
- Single Rear Axle Suspensions - Kenworth, Reyco and Hendrickson with capacities from 20,000 to 31,000 lbs.
- Dual Rear Axle Suspensions - Kenworth, Reyco, Hendrickson and Chalmers with capacities up to 46,000 lbs.
- Brakes - Air
- Brakes - Hydraulic
- ABS System - Bendix
- Hydraulic Brake Configurations with Meritor ABS

Wheels / Tires

- Wheels - Steel 22.5"
- Tires - Bridgestone 295/75R22.5 R250F
- Polished Aluminum Wheels
- 19.5" Tires and Wheels

Fuel Tanks

- Steel - Rectangular 45 Gallon
- 22" Round Aluminum - 56 to 120 Gallon Capacity
- 24.5" Round Aluminum - 56, 75, 90 and 100 Gallon Capacity Under Cab
- Polished Aluminum Tanks and Straps
- End of Frame Between the Rails Fuel Tank, 45 and 70 Gallon Capacity

Battery Boxes / Bumpers

- Steel Battery Box with Aluminum Step Cover
- Steel Aero-Style Painted Bumper
- Chrome Steel Aero-Style Bumper
- Narrow Battery Box Under Cab
- Toolbox

Cab / Hood / Interior

- Cab - Aluminum and Composite
- Hood - 4-Piece SMC - Sloped Aerodynamic Hood
- Standard Pinnacle Vinyl Headliner and Cab Back Panel
- Apex Cloth Headliner and Cab Back Panel
- Kenworth Air-Cushion Plus Intermediate Back Driver Seat
- Kenworth Intermediate Back Toolbox Plus Rider Seat
- 2-Person Bench Seat
- Power Door Locks
- Passenger-side Electric Window
- Rear Cab Corner Windows
- Trust Walnut Wood Dash Panels
- Workstation Between Seats
- Aerodynamic Roof Fairings

Special Equipment & Options

- Aerodynamic Heated Mirrors
- Back-up Alarm
- Daytime Running Lights
- Multi-function Engine Connector For Body Builder Interface
- Bodybuilder Harness to End of Frame
- Adjustable Telescoping Tilt Steering Column
- Remote Keyless Entry
- Nav+ HD

T170 SPECIFIC SPECIFICATIONS AND OPTIONS

Frame / Axle / Suspension / Brakes

- Frame - 9 7/8" Steel - 120,000 psi - Heat Treated
- Front Axles - Dana Spicer, 8,000 lb.
- Front Springs - Taperleaf w/Shocks, 8,000 lb.
- Rear Axle - Dana Spicer, 11,500 lb.
- Rear Suspension - Reyco, 13,500 lb.
- Brakes - Hydraulic
- ABS System - Meritor

Wheels / Tires

- Wheels - Steel 19.5"
- Optional Polished Aluminum 19.5"
- Tires - Bridgestone 245/70R19.5"

Fuel Tanks

- Steel - Rectangular 45 Gallon
- Optional Dual 45 Gallon

Battery Boxes / Bumpers

- Steel Battery Box and ABS Cover
- Bumpers - Steel Aero-Style Painted Gray

Optional Items in Italics

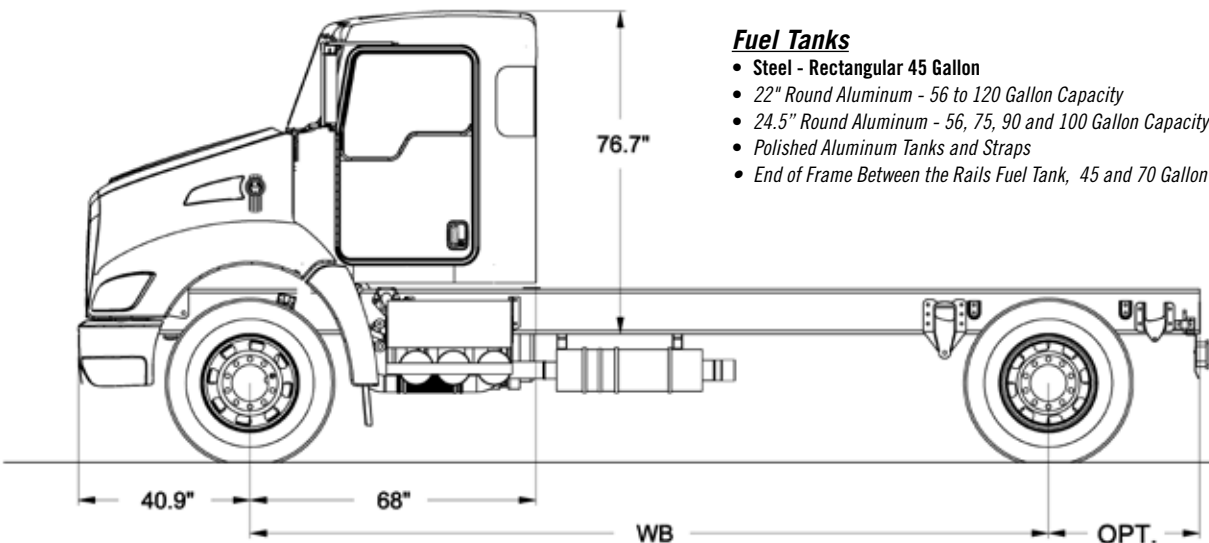

Hydraulic Brake Wheelbases: 153", 162", 176", 188", 206", 218", 236", 245", 254", 260" & 272"
Air Brake Wheelbases available in custom lengths.

HEAVY-DUTY SUPPORT WHENEVER - AND WHEREEVER - YOU NEED IT

The reliability and moneymaking potential of your business relies on the dependability of your support system – another great reason to invest in a Kenworth.



The minute you take delivery of your Kenworth, you gain 24/7 access to one of the most extensive and reliable parts and service organizations in the trucking industry. People dedicated to helping you maximize uptime, optimize truck performance and profit from your investment. When your truck needs attention – no matter the make or model – PremierCare ExpressLane® guarantees a professional service assessment and an estimate of the time and cost of repair within two hours. When you want to know your options. Now.



Perhaps you'd prefer to focus your attention and resources on your core business, save interest expense and improve cash flow. PacLease offers a number of truck rental and leasing programs that can be tailored to fit your operating requirements precisely. www.paclease.com

Start with a lender who understands your business. PACCAR Financial has served owner-operators and fleets for nearly 50 years, matching individual requirements with customized financing packages at attractive and competitive rates. Financing has never been this easy. www.paccarfinancial.com



A PACCAR COMPANY

KENWORTH TRUCK COMPANY
P.O. Box 1000
Kirkland, Washington 98083-1000
(425) 828-5000

CANADIAN KENWORTH COMPANY
6711 Mississauga Road N.
Mississauga, Ontario L5N 4J8
(905) 858-7000



Note: Equipment and specifications shown in this brochure are subject to change without notice. Consult with your Kenworth dealer at time of ordering for standard and optional equipment.

T170/T270/T370/15

© 2015 Kenworth Truck Co.